

## Shed for Rent in Seveso

Rent

Ref. 30011

PRICE: € 11.667  
negotiable



**3.500 sq.m**

### Property Informations

Zip Code: 20822

---> Totale\_mq\_calpestabili <---: 3100.00

State of Preservation: Discreet

Local processing sq.m.: 1.050 sq.m

Warehouse rooms sq.m.: 1.300 sq.m

Office sq.m.: 100 sq.m

Loft sq.m.: 200 sq.m

Services sq.m.: 1 sq.m

Courtyard sq.m.: 1.000 sq.m

Covered area sq.m.: 850 sq.m

Uncovered area sq.m.: 1.500 sq.m

## Nearby

Gyms	wellness centres	Football Fields	Fitness Centers
Tennis Courts	Bike Lanes	Playgrounds	Railway Station
Public Transport	Kindergarten	Elementary Schools	Schools
High Schools	Cafe	Post Offices	Shopping Centers
Municipal Offices			

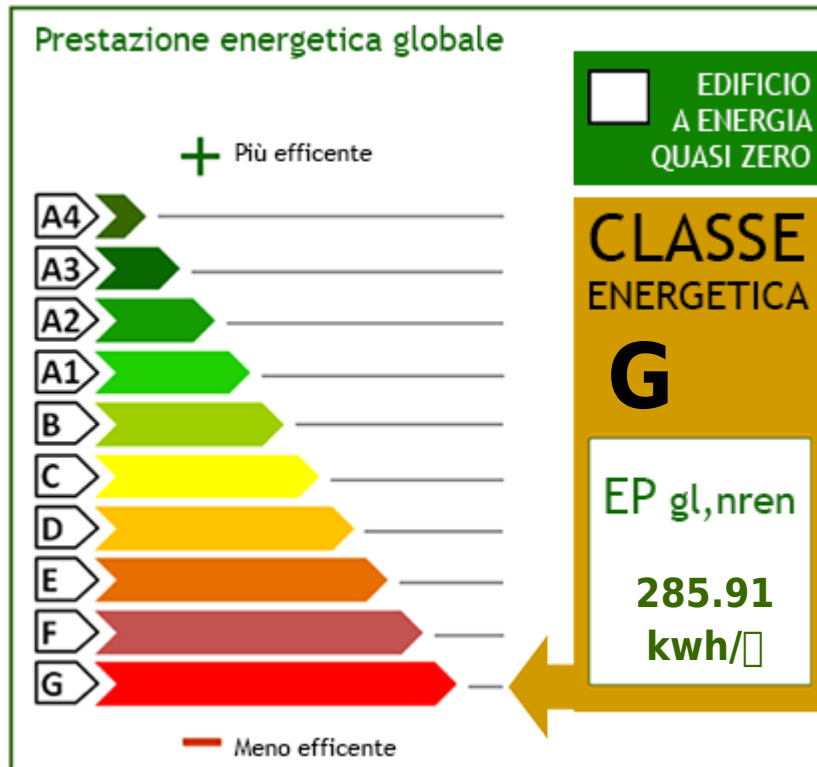



**SOGIM srl**

Via Margherita De Vizzi Viganò 93/95 - Cinisello Balsamo (MI) - Phone number 026607091  
richieste@sogim.net - <https://www.sogim.net/en>  
VAT 02533900961



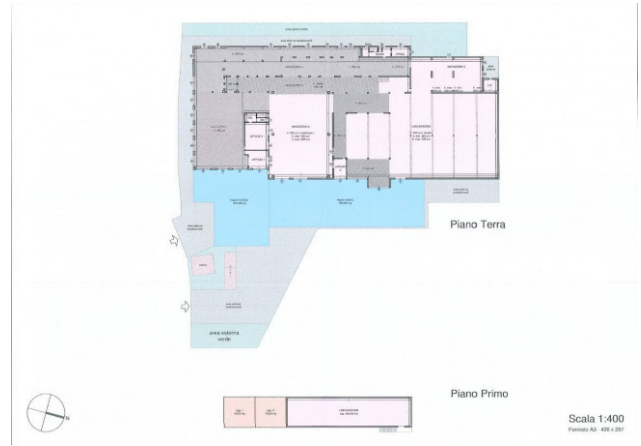

**SOGIM srl**

Via Margherita De Vizzi Viganò 93/95 - Cinisello Balsamo (MI) - Phone number 026607091  
richieste@sogim.net - <https://www.sogim.net/en>  
VAT 02533900961